



WOOD ROBSON HOMES

QUALITY+DESIGN



LIFESTYLE SERIES

Richmond

Features

- Rural lifestyle home
- 4 Bedroom, 2 bath
- Triple garage
- Open plan family dining
- Formal lounge
- Massive kitchen & Scullery
- Alfresco living space
- Optional 5th Bedroom

Areas

Living	239.43 m ²
Garage	53.57 m ²
Alfresco	25.65 m ²
Porch	3.6 m ²
Total	322.25m²
Width	27.35 m
Length	23.87 m

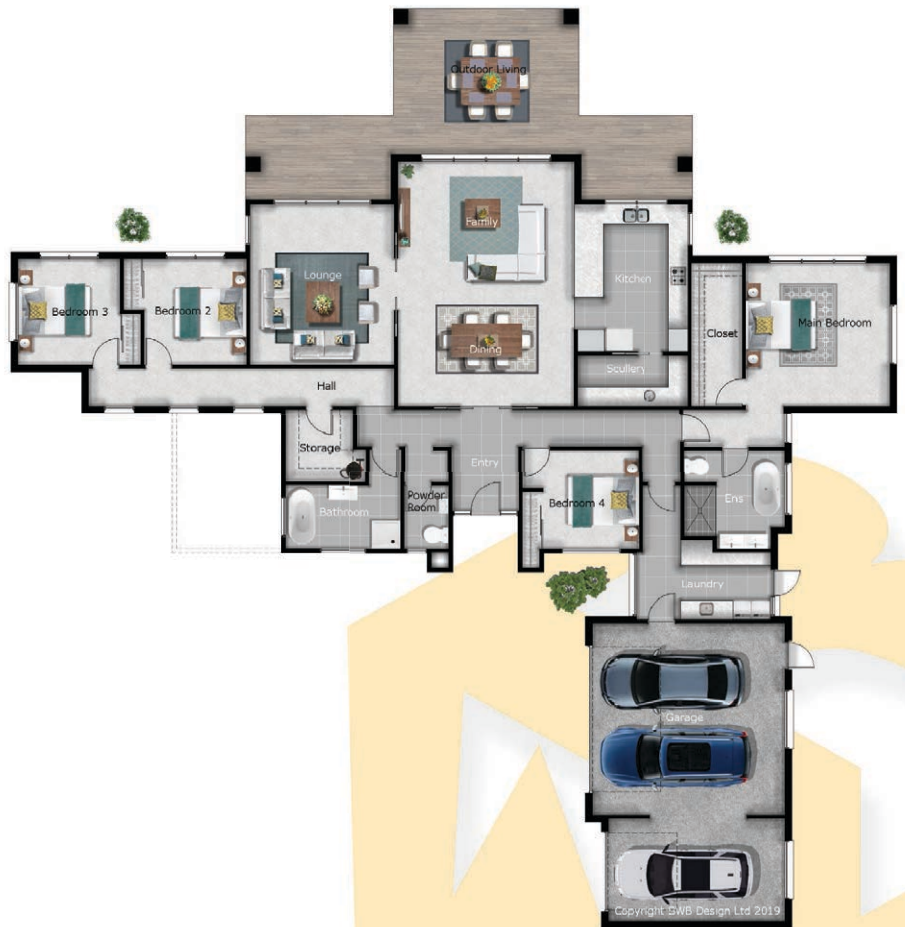

Display: 699 Tremain Ave, Palmerston North 4410 Phone: 0800 879 679 Email: sales@woodrobsonhomes.co.nz
www.woodrobsonhomes.co.nz

DISCLAIMER

PHOTOGRAPHS & ILLUSTRATIONS ARE INTENDED TO BE A VISUAL AID ONLY. WOOD ROBSON HOMES GIVES NO WARRANTY AND MAKES NO REPRESENTATION TO THE ACCURACY OR SUFFICIENCY OF ANY DESCRIPTION, ILLUSTRATION, PHOTOGRAPH OR STATEMENT CONTAINED IN THIS BROCHURE AND ACCEPTS NO LIABILITY FOR ANY LOSS SUFFERED BY ANY PERSON WHO RELIES ON EITHER WHOLLY OR PARTLY UPON THE INFORMATION PRESENTED. ALL INFORMATION IS SUBJECT TO CHANGE WITHOUT NOTICE. © COPYRIGHT WOOD ROBSON LTD